

**Technical specification**

Mounting torque: 15 ... 20 Nm  
 Operating temperature: -25°C ... +85°C  
 Media temperature: ECT: -25°C ... +125°C  
 ECT 400bar/5000psi: -10°C ... +125°C

**Type label description**

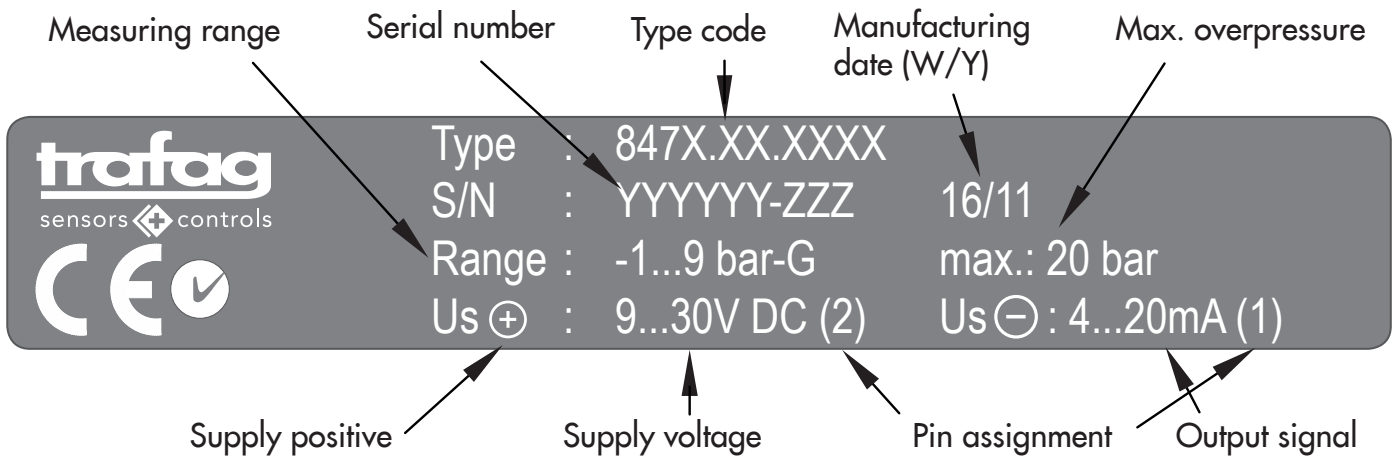

H73324i Trafag AG 11/2014

**Electrical connections**

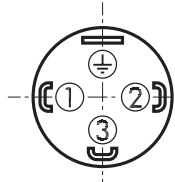
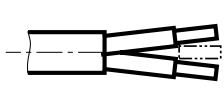
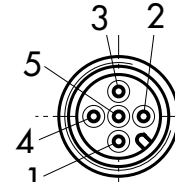
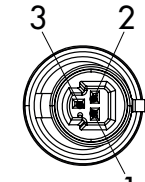
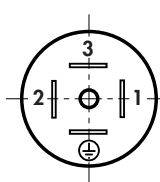
Ingress Protection	IP65 <sup>2)</sup>	IP67 / IP68 max.3m	IP67 <sup>2)</sup>	IP67 <sup>2)</sup>	IP65
Designation	EN175301-803A (DIN43650-A)	Cable (PVC) (PUR) 4 x 0.25mm <sup>2</sup>	M12x1 5-pol.	Packard Metri Pack 3-pol.	Industrial Standard contact distance 9.4 mm
Type code	847X.XX.XXXX,05	847X.XX.XXXX,22/68	847X.XX.XXXX,35	847X.XX.XXXX,51	847X.XX.XXXX,01
Pin configuration					

**Output**

4 ... 20 mA  
 0 ... 5 VDC  
 1 ... 6 VDC  
 0 ... 10 VDC  
 0.5 ... 4.5 VDC

**Load resistance**

(U<sub>Supply</sub> - 9V) / 20mA  
 > 2.5 kΩ  
 > 5.0 kΩ  
 > 5.0 kΩ  
 > 5.0 kΩ

**I<sub>SUPPLY</sub>**

<10 mA  
 <10 mA  
 <10 mA  
 <10 mA

**U<sub>SUPPLY</sub>**

9 ... 30 VDC  
 10 ... 30 VDC  
 10 ... 30 VDC  
 15 ... 30 VDC  
 5 VDC ±0.25 V

<sup>2)</sup> Provided female connector is mounted according to instructions

Ventilation via cable end/connector. Shield in the device is not connected

## Electrical connections

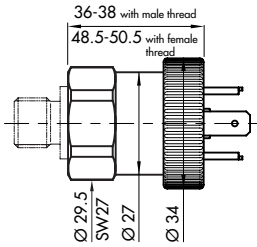

847X.XX.XXXX.05.XX.XX

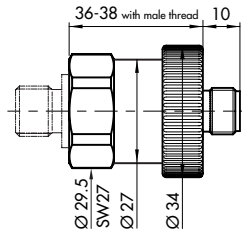

847X.XX.XXXX.35.XX.XX

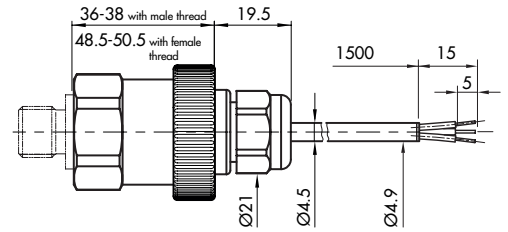

847X.XX.XXXX.22.XX.XX

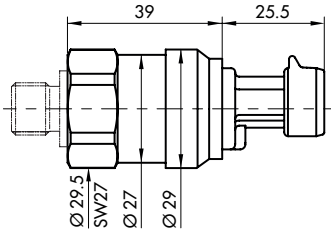

847X.XX.XXXX.51.XX.XX

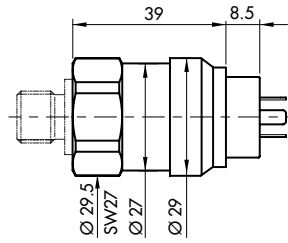

847X.XX.XXXX.01.XX.XX

## Pressure connections

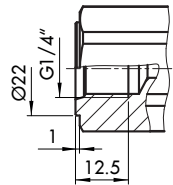

847X.XX.XX10.XX...

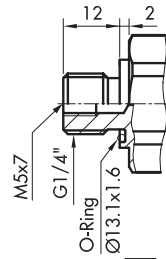

847X.XX.XX17.XX...

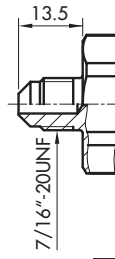

847X.XX.XX18.XX...

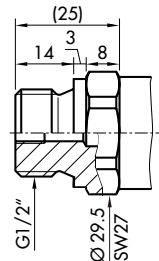

847X.XX.XX21.XX...

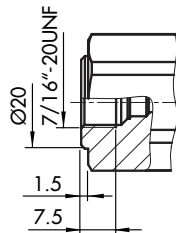

847X.XX.XX24.XX...

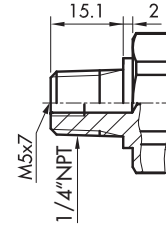

847X.XX.XX30.XX...

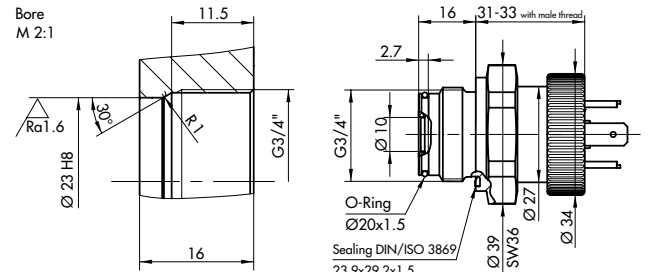

847X.XX.XX52.XX...

## Connection of the measuring equipment

### Current output

#### 2-wires

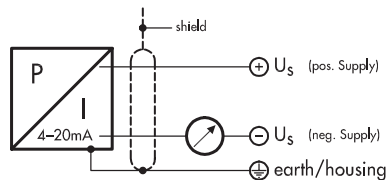

### multiple arrangement

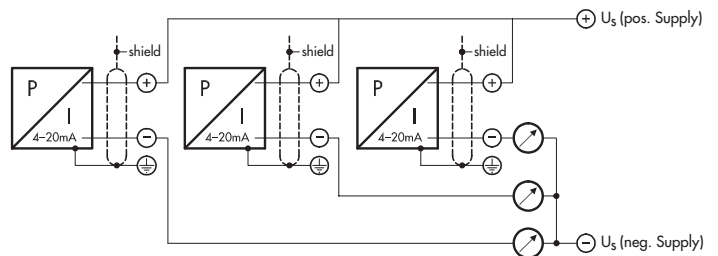

### Voltage output

#### 3-wires

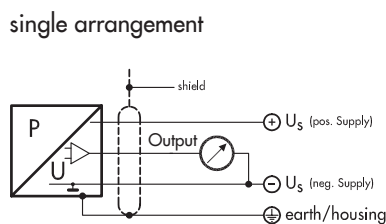

### multiple arrangement

