



**FEATURES / BENEFITS**

- Many standard port and mounting options
- Custom design and engineering available
- Miniature size, lightweight, low cost
- Quick response time
- Dependable long life (20+ million cycles)
- Gold contact points
- PCB terminals available
- Factory set, tamper proof



**SPECIFICATIONS**

**MECHANICAL**

Standard Tolerance	±20% (Tighter tolerances available)
Switch Type	SPST normally open   normally closed optional
Switching Medium	Air; compatible fluids on "High" port side
Mechanical Life	More than 20 million cycles
Proof Pressure	8 psi: for units where set point is 3.0" H <sub>2</sub> O or less 15 psi: for units where set point is greater than 3.0" H <sub>2</sub> O 8 psi: for units with Teflon® diaphragm
Operating Temp.	+40°F to +150°F (standard)   -46°F to +205°F (contact us)

**PHYSICAL**

Case Material	Polycarbonate (optional: Lexan 141, Supec®, Ultem®, Noryl®)
Porting Options	Many standard ports - see Low Port / High Port Options next page
Diaphragm Material	Polyurethane (Teflon® optional)
Contact Points	Gold
Electrical Connections	Terminals – .187" x .020" tab-type (bifurcated), for use with quick disconnects (ref. AMP 2-520182-2 or equivalent) .020" x .060" (PCB terminals available)
Mounting	#4 Screws through mounting lugs; #2 Screws through eyelets; mounting clip or bracket available (see page 15)
Weight	Less than 10 grams

**ELECTRICAL**

Current Rating	40mA resistive for life in excess of 20 million cycles
Operating Voltage	AC/DC – 30V or less with resistive load; 120 VAC neon lamp load

Note: For higher load capabilities see our PSF103, PSF109 and Goldtech series switches.

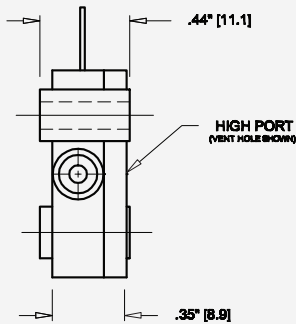
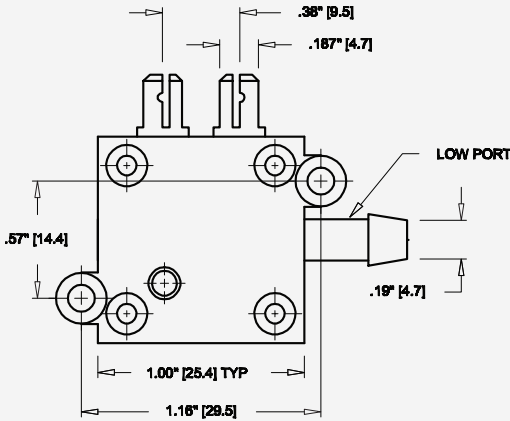

Shown with Low Port Option #5 / High Port Option #6



# DESIGNFLEX STANDARD OPTIONS

World Magnetics' exclusive DesignFlex™ feature allows you to quickly custom design a proven pressure, vacuum or differential switch for your application. Choose from our standard PSF101 options as shown or contact our vertically integrated in-house design and engineering team for special features and unique application needs. FREE sample switch available by request.

## SET POINT OPTIONS

	005	010	015	020	030	040	060	080	100	120	150	200	300	400	500
In. H <sub>2</sub> O	.1 - .5	1.0	1.5	2.0	3.0	4.0	6.0	8.0	10.0	12.0	15.0	20.0	30.0	40.0	50.0
mbar	.25 - 1.25	2.49	3.73	4.97	7.46	9.95	14.92	19.89	24.86	29.84	37.30	49.73	74.59	99.46	124.32
psi	.004 - .018	.036	.054	.072	.108	.144	.217	.289	.361	.433	.541	.722	1.083	1.444	1.084

## LOW PORT OPTIONS

## HIGH PORT OPTIONS

<b>1</b>		<b>2</b>		<b>1</b>		<b>2</b>		<b>3</b>	
Smooth Port .156" diameter for 1/8" ID tubing w/mtg. lugs		Smooth Port .156" diameter for 1/8" ID tubing w/o mtg. lugs		Smooth Port .156" diameter for 1/8" ID tubing		Smooth Port .187" diameter for 5/32" ID tubing		Smooth Port .250" diameter for 7/32" ID tubing	
<b>3</b>		<b>4</b>		<b>5</b>		<b>4</b>		<b>5</b>	
Smooth Port .250" diameter for 7/32" ID tubing w/mtg. lugs		Smooth Port .250" diameter for 7/32" ID tubing w/o mtg. lugs		Barbed Port for 3/16" ID tubing w/mtg. lugs		1/8" NPT Port		Barbed Port for 3/16" ID tubing	
<b>6</b>		<b>7</b>		<b>8</b>		<b>6</b>		<b>7</b>	
Barbed Port for 3/16" ID tubing w/o mtg. lugs		No Port (.060" vent hole) w/mtg. lugs		No Port (.060" vent hole) w/o mtg. lugs		No Port (.060" vent hole)		Flow-Thru Barbed Port for 1/8" ID tubing	
<b>9</b>		<b>0</b>		<b>Diaphragm Options</b> <b>1</b> Polyurethane (standard) <b>2</b> Teflon (optional)		<b>8</b>		<b>9</b>	
Barbed Port for 1/8" ID tubing w/mtg. lugs		Barbed Port for 1/8" ID tubing w/o mtg. lugs				Barbed Port for 1/8" ID tubing		1/4" Port for Quick Connect Fitting	

### Model Design Guide

For building standard model order number

PSF101 Series Number    Low Port Option Number    High Port Option Number    Diaphragm Option Number    Three Digit Set Point Option Number

**8**